

art. 184 ASTRA

design: Studio Reguitti
 materiale: Ottone
 material: Solid Brass

Brass Class
 100% Ottone

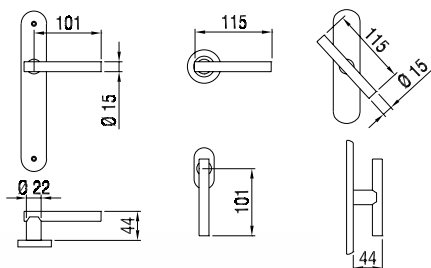

184 MR 009 OS/LV



184 MR 416 OC



184 MR 005 OC



184 MR 005 OSC/OC



184 MR 005 OS/LV



184 MR 005 OC/LV

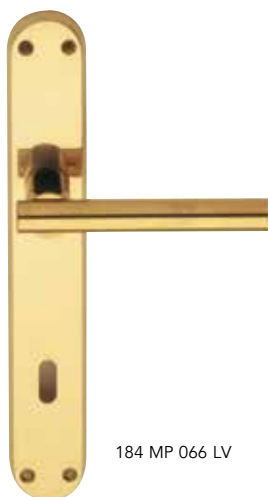

184 MP 066 LV



184 MA 070 LV
 184 CR 070 LV



184 DK 015 LV



Finiture
Finishes

					LV OS/LV	OSC OC	OC/LV OSC/OC	
MANIGLIA CON PLACCA / LEVER HANDLE ON PLATE								
	184 MP 066	Maniglia con placca Lever Handle on plate	066 mm 240x37	con molla e grano with spring and grub screw	•	•	•	1
	184 MP 130	Maniglia con placca Lever Handle on plate	130 mm 245x50	con molla e grano with spring and grub screw	•	•	•	1
MANIGLIA CON ROSETTA / LEVER HANDLE ON ROSE								
	184 MR 005	Maniglia con rosetta Lever Handle on rose	005 mm Ø50x8	tipo lusso con molla e grano luxu type with spring and grub screw	•	•	•	2
	184 MR 009	Maniglia con rosetta Lever Handle on rose	009 mm 62x32	ovale con molla e grano oval with spring and grub screw	•	•	•	1
	184 MR 416	Maniglia con rosetta Lever Handle on rose	416 mm Ø45x9	con molla e grano with spring and grub screw	•	•	•	1
	184 MR Q86	Maniglia con rosetta Lever Handle on rose	Q86 mm 50x50	con molla e grano with spring and grub screw	•	•	•	1
CREMONESE / WINDOW HANDLE WITH MECHANISM								
	184 CR 137	Cremonese con placca Window Handle on plate	137 mm 167x40	con fori viti con gioco with holes for screws with mechanism	•	•	•	2
	184 CR 070*	Cremonese con placca Window Handle on plate	070 mm 189x36	coprivite con gioco with cover-screw plate with mechanism	•	•	•	2
MARTELLINA / WINDOW HANDLE WITHOUT MECHANISM								
	184 MA 137	Martellina con placca Window Handle on plate	137 mm 167x40	con fori viti q.7 with holes for screws with square-pin mm 7	•	•	•	2
	184 MA 070*	Martellina con placca Window Handle on plate	070 mm 189x36	coprivite q.7 with cover-screw plate with square-pin mm 7	•	•	•	2
DREH KIPP / DREH KIPP								
	184 DK 015	Dreh Kipp con rosetta Dreh Kipp on rose	015 mm 65x31	con movimento in metallo with metal mechanism	•	•	•	3

* Placca adatta a movimenti intercambiabili
Plate suitable to interchangeable movements



184 MR Q86 OC



184 MD 005 LV

Vedi capitolo "Porte d'entrata"
See chapter "Entrance doors"



184 MP 066 OSC



184 MP 130 OSC

Per caratteristiche tecniche rosette vedi apposito capitolo soluzioni tecniche e componenti / For technical specifications rosettes see specific section technical solutions and components

A RICHIESTA / ON REQUEST:

- Mezza maniglia con placca o con rosetta (specificare se destra o sinistra) / Half lever handle on plate or on rose (to specify if right or left)
- Maniglia con rosette senza bocchette / Lever handle on rose without rose for key
- Coppie impugnature (CM) con grano e ferro senza rosette e senza bocchette / Pair levers (CM) with grub screws and square pin without rose and without rose for key
- Cremonesi e martelline con impugnatura a maniglia (segretini)