

art. **185** ALMA

design: Marco Pialorsi  
 materiale: Ottone  
 material: Solid Brass

**Brass Class**  
 100% Ottone

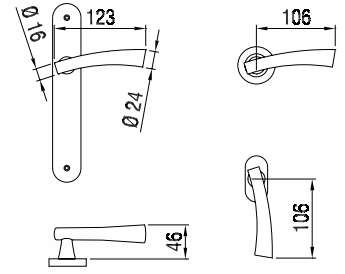

185 MR 006 LV



185 MR 816 OSC



185 MR 416 OC



185 MR 006 OSC



185 MR 006 OS/LV



185 MR 006 OC/LV



185 MP 248 OSC



185 MP 188 LV

destra/right



185 SE 070 LV  
 185 SG 070 LV

VERSIONI / VERSIONS



Finiture  
Finishes

					LV OS/LV	OSC OC	OSC/OC OC/LV	
<b>MANIGLIA CON PLACCA / LEVER HANDLE ON PLATE</b>								
	185 MP 188	Maniglia con placca Lever Handle on plate	188 mm 255x42	con molla e grano with spring and grub screw	•	•	•	1
	185 MP 130	Maniglia con placca Lever Handle on plate	130 mm 245x50	con molla e grano with spring and grub screw	•	•	•	1
	185 MP 248	Maniglia con placca Lever Handle on plate	248 mm 248x50	con molla e grano with spring and grub screw	•	•	•	1
<b>MANIGLIA CON ROSETTA / LEVER HANDLE ON ROSE</b>								
	185 MR 006	Maniglia con rosetta Lever Handle on rose	006 mm Ø50x8	tipo lusso con molla e grano lusso type with spring and grub screw	•	•	•	1
	185 MR 416	Maniglia con rosetta Lever Handle on rose	416 mm Ø45x9	con molla e grano with spring and grub screw	•	•	•	1
	185 MR 816	Maniglia con rosetta Lever Handle on rose	816 mm Ø50x10	con molla e grano with spring and grub screw	•	•	•	1
<b>CREMONESE / WINDOW HANDLE WITH MECHANISM</b>								
	185 SG 137	Cremonese con placca Window Handle on plate	137 mm 167x40	con fori viti con gioco with holes for screws with mechanism	•	•	•	2
	185 SG 070*	Cremonese con placca Window Handle on plate	070 mm 189x36	coprivite con gioco with cover-screw plate with mechanism	•	•	•	2
<b>MARTELLINA / WINDOW HANDLE WITHOUT MECHANISM</b>								
	185 SE 137	Martellina con placca Window Handle on plate	137 mm 167x40	con fori viti q.7 with holes for screws with square-pin mm 7	•	•	•	2
	185 SE 070*	Martellina con placca Window Handle on plate	070 mm 189x36	coprivite q.7 with cover-screw plate with square-pin mm 7	•	•	•	2
<b>DREH KIPP / DREH KIPP</b>								
	185 DK 015	Dreh Kipp destro con rosetta Dreh Kipp (right) on rose	015 mm 65x31	con movimento in metallo with metal mechanism	•	•	•	3

\* Placca adatta a movimenti intercambiabili  
Plate suitable to interchangeable movements

destro/right



185 DK 015 LV



185 MP 130 OSC



185 MS 002 PVD

Vedi capitolo "Porte d'entrata"  
See chapter "Entrance doors"

Per caratteristiche tecniche rosette vedi apposito capitolo soluzioni tecniche e componenti / For technical specifications rosettes see specific section technical solutions and components

**A RICHIESTA / ON REQUEST:**

- Mezza maniglia con placca o con rosetta (specificare se destra o sinistra) / Half lever handle on plate or on rose (to specify if right or left)
- Maniglia con rosette senza bocchette / Lever handle on rose without rose for key
- Coppie impugnature (CM) con grano e ferro senza rosette e senza bocchette / Pair levers (CM) with grub screws and square pin without rose and without rose for key