

art. 171 ALISE'

design: Studio Reguitti
 materiale: Impugnatura Zama
 material: Lever Zamak

TeKnoMetal
 Linea in zama

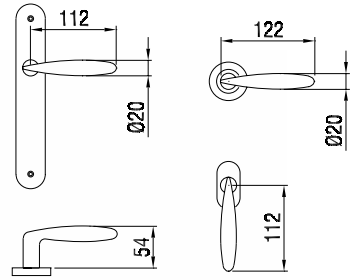

171 MR 006 ZSC



171 MR 004 ZSC



171 MR 008 SNV



171 MR 009 ZSC



171 MR 816 SNV



171 MR 007 ZCR



171 MP 188 ZSC



171 SE 070 ZSC
 171 SG 070 ZSC



171 DK 024 ZSC



						ZSC ZCR	SNV	NR	PVD	
MANIGLIA CON PLACCA / LEVER HANDLE ON PLATE										
	171 MP 188	Maniglia con placca Lever Handle on plate	188	mm 255x42	con molla e grano with spring and grub screw	•			•	1
	171 MP 026	Maniglia con placca Lever Handle on plate	026	mm 225x26	"stretta" con grano reduced with grub screw	•				1
MANIGLIA CON ROSETTA / LEVER HANDLE ON ROSE										
	171 MR 004	Maniglia con rosetta Lever Handle on rose	004	mm Ø45x9	con molla e grano with spring and grub screw	•	•	•	•	2
	171 MR 006	Maniglia con rosetta Lever Handle on rose	006	mm Ø50x8	tipo lusso con molla e grano luxu type with spring and grub screw	•	•		•	2
	171 MR 007	Maniglia con rosetta Lever Handle on rose	007	mm 67x27	ovale stretta con grano oval and reduced with grub screw	•				2
	171 MR 008	Maniglia con rosetta Lever Handle on rose	008	mm Ø50x8	con molla e grano with spring and grub screw	•	•			2
	171 MR 009	Maniglia con rosetta Lever Handle on rose	009	mm 62x32	ovale con molla e grano oval with spring and grub screw	•			•	1
	171 MR 416	Maniglia con rosetta Lever Handle on rose	416	mm Ø45x9	con molla e grano with spring and grub screw	•	•	•	•	1
	171 MR 816	Maniglia con rosetta Lever Handle on rose	816	mm Ø50x10	con molla e grano with spring and grub screw	•	•			1
	171 MR 916	Maniglia con rosetta Lever Handle on rose	916	mm 62x32	ovale con molla e grano oval with spring and grub screw	•	•			1
CREMONESE / WINDOW HANDLE WITH MECHANISM										
	171 SG 070*	Cremonese con placca Window Handle on plate	070	mm 189x36	coprivite con gioco with cover-screw plate with mechanism	•				2
MARTELLINA / WINDOW HANDLE WITHOUT MECHANISM										
	171 SE 070*	Martellina con placca Window Handle on plate	070	mm 189x36	coprivite q. 7 with cover-screw plate with square-pin mm 7	•				2
DREH KIPP / DREH KIPP										
	171 DK 015	Dreh Kipp con rosetta Dreh Kipp on rose	015	mm 65x31	con movimento in metallo with metal mechanism	•	•	•	•	3
	171 DK 024	Dreh Kipp con rosetta Dreh Kipp on rose	024	mm 65x31	c/mov. in metallo e quadro autoregolante with metal mec. and adjustable square-pin	•			•	3

* Placca adatta a movimenti intercambiabili
Plate suitable to interchangeable movements



171 MR 009 PVD



171 MR 416 NR



171 MP 026 ZCR



171 MR 916 ZSC

Per caratteristiche tecniche rosette vedi apposito capitolo soluzioni tecniche e componenti / For technical specifications rosettes see specific section technical solutions and components

A RICHIESTA / ON REQUEST:

- Mezza maniglia con placca o con rosetta (specificare se destra o sinistra) / Half lever handle on plate or on rose (to specify if right or left)
- Maniglia con rosette senza bocchette / Lever handle on rose without rose for key
- Coppie impugnature (CM) con grano e ferro senza rosette e senza bocchette / Pair levers (CM) with grub screws and square pin without rose and without rose for key